

# Reactor multipoint questionnaire

## To determine radial temperature profiles

### Model TC96-R (Flex-R®)



#### Customer data

Company	Date
Name	Phone
Department	Mobile
Address	Fax
	E-mail

#### Licensor

Licensor name

Application  Refinery  Petrochemical industry

#### Vessel data

Type of vessel  Process unit

Name of vessel

Vessel dimensions  Diameter  Height

Vessel material

Vessel condition  Used (in service)  New

Temperatures  Process  Max. design temperature

Pressure  Process  Max. design pressure

Mounting  Horizontal  Vertical

#### Sensor data

Type of sensor  Type of thermocouple  Grounded  Ungrounded

Thermocouple calibrated  Yes  No

Number of points  *(see „Point location“ on page 2)*

MI cable material  MI cable diameter

Secondary containment  Yes  No

Pressure monitoring  Yes  No

## Process data

Process connection	Type	Nominal width	Material
	Rating	Schedule (rating of nozzle)	
	ID of nozzle	Unit of measure	

## Non destructive testings

Pressure test wetted parts	Yes	No
----------------------------	-----	----

## On-site service

On-site service

## Point location

Please draw the desired point location in the illustration on the right so that WIKA/Gayesco can take them into account when preparing the offer.

Reactor drawings attached

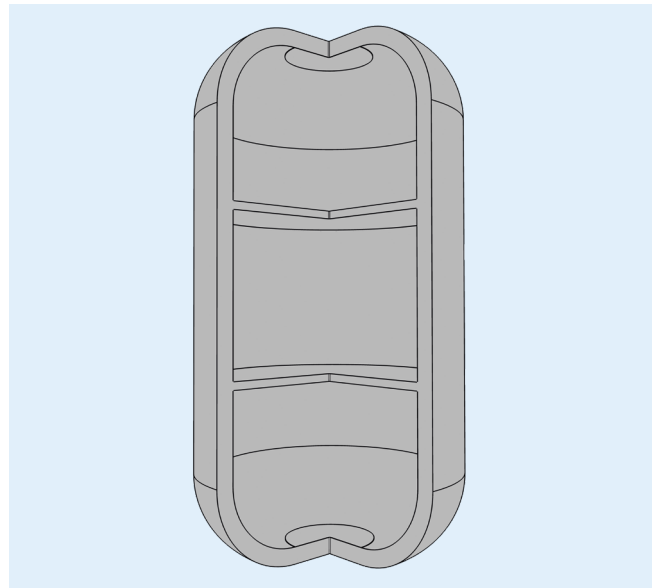

## Additional notes

---

---

---

---

---

